



**126 Royal Lane
Uxbridge, UB8 3QY
£2,420 PCM**

Deposit required £2,792

**Available date 25th
September 2025**

****STUDENTS****

4 BEDROOMS - AVAILABLE 25/09/2026

The rental payments equate to approx £605 per person per month or £140 per person per week excluding bills. UniHomes offer a bills package for £26 ppp week. (Incl Mains Gas, Electric, Water/Sewage, TV licence and internet) which can be organised through Nupad initially.

COUNCIL TAX BAND D
EPC D

Nupad offer this excellent 4-bedroom house comprising of FOUR FURNISHED BEDROOMS, a LOUNGE, BATHROOM AND KITCHEN and DINING ROOM. Off street parking and rear garden.

The property is ideal for students at Brunel University as it's walking distance to the university. It is also nearby to direct bus routes to Uxbridge Town Centre, Heathrow, Stockley Park and the local underground station.

ENTRANCE FLOOR
593 sq.ft. (55.1 sq.m.) approx.

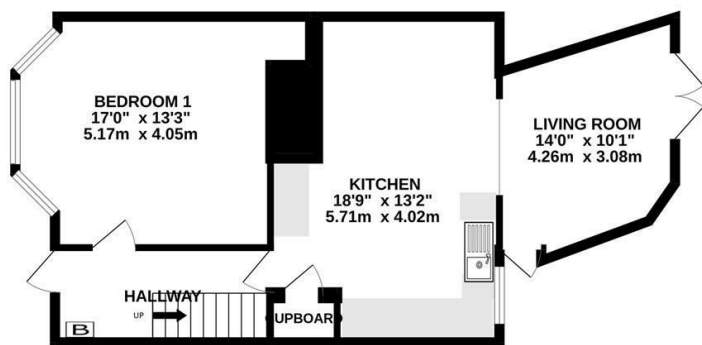

FIRST FLOOR
537 sq.ft. (49.9 sq.m.) approx.

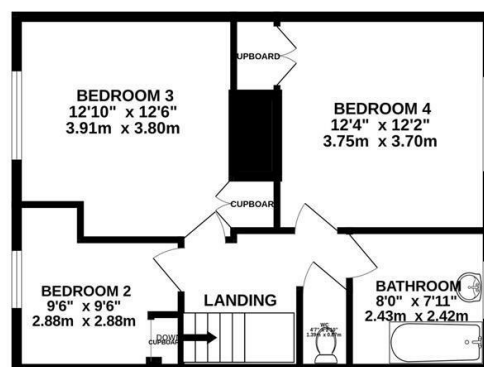

TOTAL FLOOR AREA : 1130 sq.ft. (105.0 sq.m.) approx.

Whilst every attempt has been made to ensure the accuracy of the floorplan contained here, measurements of doors, windows, rooms and any other items are approximate and no responsibility is taken for any error, omission or mis-statement. This plan is for illustrative purposes only and should be used as such by any prospective purchaser. The services, systems and appliances shown have not been tested and no guarantee as to their operability or efficiency can be given.
Made with Metropix ©2025

